

Courses and distances down the creek
from uproot

N. 56. E. 18
N. 56. E. 20 to post
38 in all

C152-63

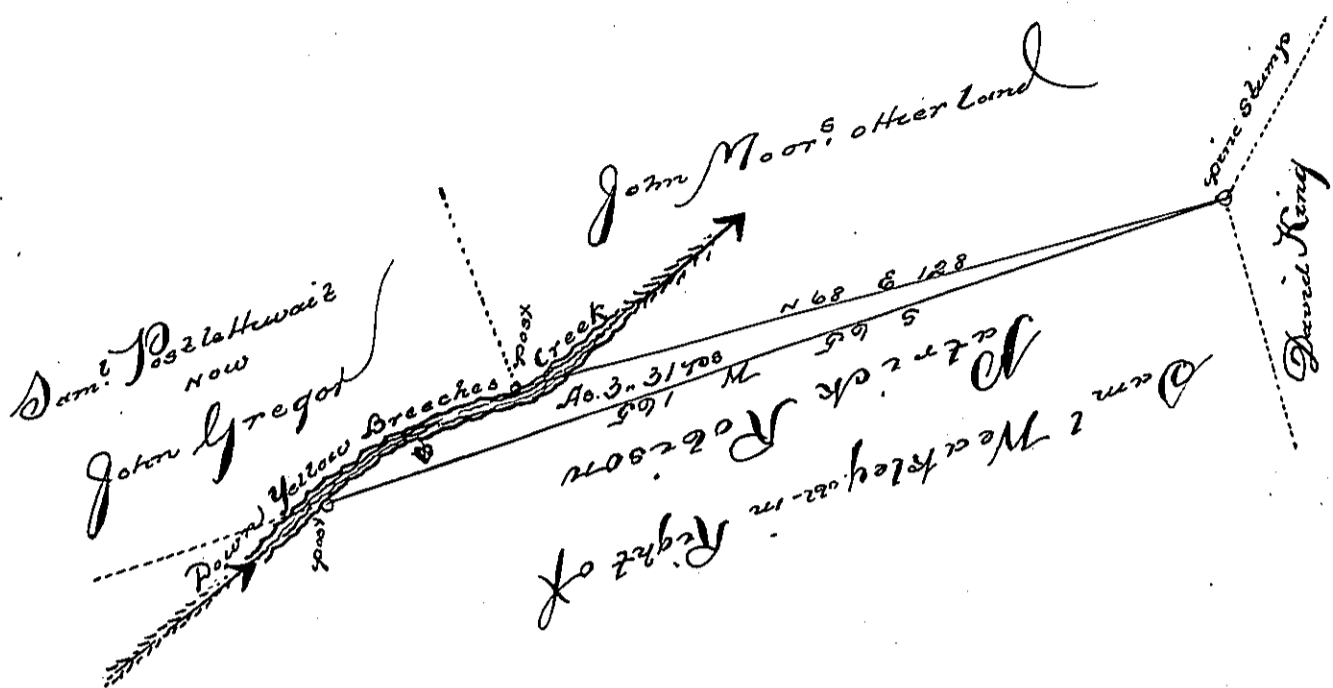

The Draught of a tract of Land situated in Dickinson Township Cumberland
 Land County containing three acres & thirty one perches & arrows of
 six p Cent for Roads the Survey, the 16th day of January 1802 on a
 warrant granted to John Moor Dated the 21st Day of March 1793

Wm Ramsey A.S.

To Sam^l Cochran Esquire
 Surveyor Gen^l of Pennsylvania

N.B: This Survey Disputed by Sam^l Weakley Esq^r upon a
 right in the name of Patrick Robinson

Wm Ramsey A.S.

IN TESTIMONY that the above is a copy of the original remaining on file in the
 Department of Internal Affairs of Pennsylvania, made con-
 formably to an Act of Assembly approved the 16th day of
 February, 1833, I have hereunto set my Hand and caused
 the Seal of said Department to be affixed at Harrisburg, this

third day of August 1897

James W. Latta
 Secretary of Internal Affairs.